

## Industrial Glass - [Pipeline Components](#) - Crosses

### UNEQUAL CROSSES

Cat.Ref.	DN	DN1	DN2	L	L1	L2
PXU2/1/1	50	25	25	200	80	80
PXU2/1.5/1*	50	40	25	200	100	80
PXU3/1/1*	80	25	25	250	100	100
PXU3/1.5/1*	80	40	25	250	100	100
PXU3/2/1	80	50	25	250	115	100
PXU4/1/1	100	25	25	250	110	110
PXU4/1.5/1*	100	40	25	250	125	110
PXU4/2/1*	100	50	25	250	125	110
PTU4/3/1*	100	80	25	300	150	150
PXU6/1.5/1*	150	40	25	250	150	150
PXU6/2/1*	150	50	25	250	150	150
PXU6/3/2*	150	80	50	300	175	150
PXU6/4/2	150	100	80	300	200	150
PXU9/1.5/1.5*	225	40	40	300	185	185
PXU9/2/1.5	225	50	40	300	185	185
PXU9/3/1.5*	225	80	40	300	210	185
PXU9/4/2*	225	100	50	450	250	185
PXU9/6/3	225	150	80	450	275	210
PXU12/2/1.5	300	50	40	400	230	230
PXU12/3/1.5	300	80	40	400	275	230
PXU12/4/1.5*	300	100	40	400	275	230
PXU12/6/2*	300	150	50	450	300	230
PXU12/9/3	300	225	80	600	300	275
PXU16/1.5/1.5	400	40	40	400	275	275
PXU16/3/1.5	400	80	40	400	300	275
PXU16/4/1.5	400	100	40	400	300	275
PXU16/6/3	400	150	80	500	350	300

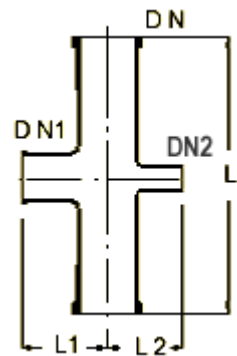

PXU16/9/4	400	225	100	800	450	300
PXU18/1.5/1.5	450	40	40	400	300	300
PXU18/3/1.5	450	80	40	400	320	300
PXU18/4/1.5	450	100	40	400	320	300
PXU18/6/3	450	150	80	600	380	320
PXU18/9/4	450	225	100	800	400	320

### CROSSES

Cat.Ref.	DN	L
PX1*	25	100
PX1.5*	40	150
PX2	50	150
PX3	80	200
PX4	100	250

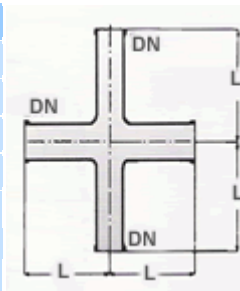

### CLOSURES

Cat.Ref.	DN	L
PBE1*	25	50
PBE1.5*	40	75
PBE2*	50	75
PBE3	80	100
PBE4	100	125
PBE6	150	125
PBE9	225	150
PBE12	300	150



### BLINDS

Cat.Ref.	DN	L
PBF1*	25	8
PBF1.5*	40	8
PBF2*	50	8
PBF3*	80	8
PBF4*	100	8
PBF6	150	9
PBF9	225	9
PBF12	300	9

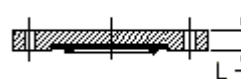

\* marked items are available fast.

